



**Fiber glass acoustic batt insulation designed to absorb sound vibrations in wall, floor and ceiling applications for noise control.**

## QuietZone® Acoustic Batts

Owens Corning *QuietZone* acoustic batts are an essential part of controlling noise transmission between rooms. The *QuietZone* acoustic batt actually absorbs sound vibrations within the wall cavity to control noise in the home.

*QuietZone* acoustic batts reduce noise transmission coming from laundry rooms, entertainment rooms, family rooms and any other area where noise is created. It can also be used to create privacy in home offices, master bedrooms or other areas where peace and quiet is desired.

### Product Benefits:

- Differentiate the homes you build with increased performance
- Increase sales by offering unique up-sell options
- Provide homeowners with quieter, more peaceful living conditions
- Enhance your image by positioning yourself as an acoustic solutions expert
- Save homeowners time and money by suggesting noise control prior to new home construction compared to retrofitting at a later date

### Product Attributes

*QuietZone* acoustic batts are:

- Acoustically engineered to absorb sound vibrations
- Installed between interior walls, floors, and ceilings when constructed of standard wood framing members
- Lightweight and pre-cut to 93" or 105" lengths for quick installation and easy transportation
- Faced batts are easily identified by attractive, PINK-kraft facing featuring large images of the Pink Panther™
- Easily stapled and cleanly fabricated to allow for improved workmanship and acoustical performance
- Compliant with building codes and standards

### Product Applications

#### Basic Noise Control Wall Construction

Using single 2x4 wood studs (16" o.c.), *QuietZone* acoustic batts, and 1/2" Type X gypsum board provides basic noise control between adjoining rooms. *QuietZone* acoustic batts can improve conventional wood stud walls to a Sound Transmission Class (STC) rating of 39.

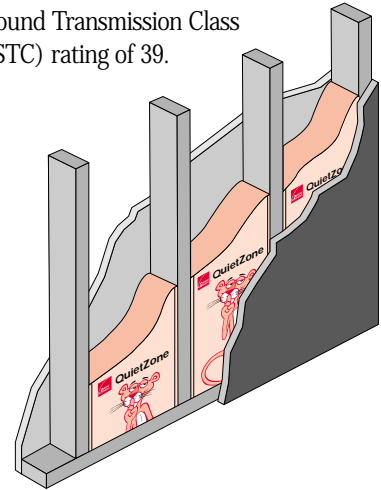

**Figure 1**

Single wood studs, *QuietZone* acoustic batt insulation and a single layer of 1/2" Type X gypsum board.

# QuietZone® Acoustic Batts

## Product Installation

*QuietZone* acoustic batts are designed for interior cavities only and are not recommended for exterior walls. The facing on this product is provided for ease of installation and is not a vapor retarder.

- Insulation must fit snugly into place, filling the cavity completely.
- Staple batts along kraft flanges to the inside of the wall framing.
- In cases where wall penetrations apply, cut with a utility knife to fit around wiring, outlets, junction boxes, pipes and other obstructions.
- For desired performance, keep batts dry during shipping, storage and installation.
- *QuietZone* acoustic batts may be installed with the facing toward either side of interior walls, floors, or ceilings in conventional wood stud construction.
- *QuietZone* acoustic batts (15" or 23" width) will be required in the cavity space between wall framing sections spaced either 16" or 24" o.c.
- Owens Corning acoustic batts will be required to fill the cavity space between wall framing sections spaced either 16" or 24" o.c. when using 2x6 *QuietZone* acoustic wall framing.

## Durable Composition

*QuietZone* acoustic batts:

- Are dimensionally stable
- Will not slump over time
- Are composed of inorganic glass fibers which do not absorb water
- Maintain original acoustic properties over time
- Will not rot or mildew

## Fire Safety

When installing *QuietZone* acoustic batts in areas containing high temperature appliances, fireplace flues or furnaces, the kraft-facing must be protected and enclosed with an approved finishing material.\*

\*The facing on *QuietZone* batts will burn and must not be left exposed. The facing must be installed in substantial contact with an approved interior material. Protect facing from any open flame or heat surface.

## Applicable Standards

*QuietZone* acoustic batts comply with ASTM C 665, Type II, Class C. Federal Specification HH-I-521F has been cancelled and is replaced by ASTM C 665. *QuietZone* acoustic batts also comply with the requirements of the Uniform Building Code (ICBO) building types III, IV, and V; National Building Code (BOCA) building types 3, 4, and 5; and Standard Building Code (SBCCI) building types III, V, and VI.

Always check with your local building code official regarding local requirements affecting installation of all building components.

For more information on *QuietZone* acoustic batts or the *QuietZone* Noise Control System, call 1-800-GET-PINK or visit our Web site at [www.owenscorning.com](http://www.owenscorning.com).

### Technical Data

#### Wood Frame Construction Faced Batt

Width	Length	Thickness	Pieces per Package	Sq ft / m <sup>2</sup>	Linear ft / m
15" 381mm	93" 2362mm	3 1/2" 89mm	16	155 / 14.40	124 / 37.8
15" 381mm	105" 2664mm	3 1/2" 89mm	16	175 / 16.26	140 / 42.7
15 1/2" 394mm	93" 2362mm	5 1/2" 139mm	10	101 / 9.38	78 / 23.8
23" 584mm	93" 2362mm	3 1/2" 89mm	16	238 / 22.11	124 / 37.8
15" 381mm	105" 2664mm	3 1/2" 89mm	1 (Roll)	88 / 8.18	70 / 21.3

#### Unfaced Batt

15 1/4" 387mm	93" 2362mm	3 1/2" 89mm	16	155 / 14.40	124 / 37.8
15 1/4" 387mm	105" 2664mm	3 1/2" 89mm	16	178 / 16.54	140 / 42.7
23 1/4" 591mm	93" 2362mm	3 1/2" 89mm	16	241 / 22.39	124 / 37.8

#### Dimensional Stability

Linear Shrinkage      Less than 0.1%

#### Water Absorption

Max. by Volume      Less than 0.05%



INNOVATIONS FOR LIVING™

**OWENS CORNING WORLD HEADQUARTERS**  
ONE OWENS CORNING PARKWAY  
TOLEDO, OHIO 43659

Pub. No. 5-BL-43824-B Printed in U.S.A., October 2002 Copyright © Owens Corning. The Pink Panther is a TM & © of United Artists Corp. Licensed by MGM Consumer Products. The color PINK is a registered trademark of Owens Corning.